



Highway 26 in Calaveras County, CA

During the heavy rainy season of 2004/2005 a 1H:1V cut slope along Highway 26 in Calaveras County, California became saturated creating a shallow slope failure.

Caltrans District 10 Maintenance, the department responsible for the repair, considered two possible solutions: the AnchorMat™ system and Rock Slope protection. AnchorMat™ was specified because it was low impact, required only hand held equipment for installation and provided an instantly attractive finish to the slope. It also meant that there was no need to purchase additional right-of-way or close the lane of the highway making it the most cost effective option.

The design included standard Platipus S4 Geos driven through Pyramat® HPTRM, on a checkerboard grid pattern, at 5ft centers. Thunder Mountain Enterprises, Inc. of Sacramento completed the installation in July of 2005.

By early September 2005 vegetation was starting to emerge. The Pyramat® HPTRM with X3™ Fiber Technology trapped the morning dew providing moisture for the seed germination.

Caltrans were particularly impressed by speed and simplicity of the construction eliminating the need for heavy equipment that would have been necessary to install the Rock Slope protection.

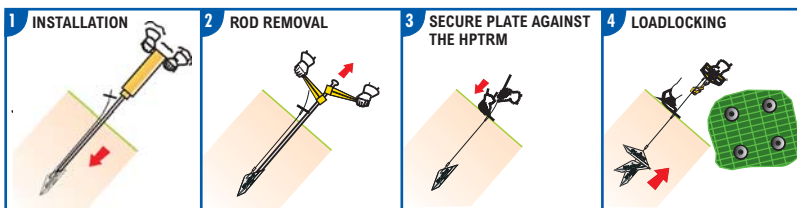
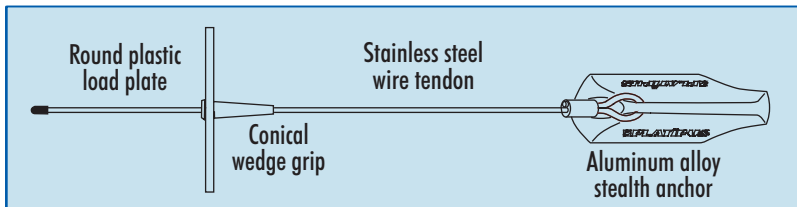

PLATIPUS
ENGINEERING SYSTEMS
1601 Pineview Drive, Raleigh, NC 27606
Phone: 866 752 8478 Fax: 919 859 9597
www.platipus-anchors.com

SI® Geosolutions
4019 Industry Drive, Chattanooga, TN 37416
Phone: 423-899-0444 Fax: 423-899-7619
www.fixsoil.com